

Epinephrine Auto-Injector Medication Authorization

to access and use prescribed medications during school
ONE FORM PER MEDICATION



Student Name _____ Date of Birth _____
Home Address _____ HR/Grade _____

Healthcare Provider to Complete:

I verify this medication has been prescribed for above student in the event of signs or symptoms of an allergic reaction and/or suspected exposure to the following allergen(s): _____

Signs or symptoms _____

Medication _____ Dosage _____ Route _____

Beginning Date _____ Expiration Date _____ or end of school year

CALL 911 when medication is administered. Repeat dose if medication does not produce relief yes no

Other medications prescribed to this student (home & school) _____

THIS SECTION IS ONLY FOR THE PERMISSION TO SELF CARRY:

- I provided the student with training in the use of an auto-injector and he/she has demonstrated its proper use. yes no
- The student is capable of possessing and self-administering the auto-injector per ORC 3317.716 and 3313.718. yes no

Per state law, I prescribed a back-up auto-injector to be kept at school for as needed use by trained staff. yes no

Healthcare Provider Signature _____ Date _____

Provider Name _____

Practice Address _____

Phone _____ Fax _____

Please fill contact information to left or stamp here

Parent to Complete:

Parent/Guardian Name _____ Phone Numbers _____ or _____

To the Parent or Guardian: The following information is necessary for any student who uses medication in school.

- Both the parent and healthcare provider portions of this form must be completed.
- A new Medication Authorization form is required each school year and when there is a change in the medication.
- I authorize the student named above to have access to and use the medication as ordered above.
- I understand my student's epinephrine auto-injector will be stored in the school medication cabinet to ensure its availability and will have the assistance of trained staff as needed.
- If my student is determined capable to self-carry and self-administer by myself, healthcare provider and school nurse, then I authorize my student to carry and use their epinephrine auto-injector as prescribed above, at school/school events: yes no.
 - I will instruct my child to inform school staff if he/she has used the auto-injector so school staff can immediately call 911.
 - I agree to provide the school with backup dose of epinephrine as required by law.
- I understand emergency medical service will be called if the epinephrine auto-injector is used. I understand the medication must be in the original container and properly labeled with student's name, date, prescriber's name, name of medication, dosage, strength, route and time of administration and drug expiration date.
- I assume responsibility for the safe delivery of the medication to school and will notify the school immediately with any medication changes.
- I authorize Grace Christian School Health Services staff to communicate with the student's healthcare provider as needed.
- I release and agree to hold the Board of Education, its officials, and its employees harmless from any and all liability for damages or injury resulting directly or indirectly from this authorization.

Parent/Guardian Signature _____ Date _____

Guidelines for Medications at School

Students needing to take medication during school hours must follow these guidelines:

- **Provide the school nurse with a completed Medication Authorization Form signed by both the parent/guardian and the healthcare provider.**

- **A new Medication Authorization Form must be completed each school year AND when the medication or dose has changed.**

- **All medication must be in the original container in which it was dispensed by the healthcare provider or pharmacy and be labeled with the correct dose and instructions.**
 - The label must match what is on the Medication Authorization Form.
 - Students taking a medication at both school and home can request 2 separate labeled bottles from the pharmacy to divide the pills to have some at home and school.
 - Students using an inhaler, epinephrine pen or other emergency medications at school can request 2 prescriptions from the healthcare provider in order to have a supply at home and school.

- **School personnel cannot give over-the-counter medications unless prescribed by a healthcare provider. A Medication Authorization Form must be completed.**

Prescribed over the counter medications follow the same guidelines as stated above for prescribed medications. (Over the counter medications include pain medication such as Tylenol, cough medicine, ointments.)

- **Medications ordered three times a day or less, unless time is specified, may not need to be taken at school. The medication should be given before school, after school and at bedtime.**

- ***All unused medication must be picked up by the parent/guardian on the last day of school/camp or it will be discarded.***

Name: _____ D.O.B.: _____

Allergy to: _____

Weight: _____ lbs.

Asthma: Yes (higher risk for a severe reaction) No

For a suspected or active food allergy reaction:

**PLACE
STUDENT'S
PICTURE
HERE**

FOR ANY OF THE FOLLOWING SEVERE SYMPTOMS

If checked, give epinephrine immediately if the allergen was definitely eaten, even if there are no symptoms.



LUNG

Short of breath, wheezing, repetitive cough



HEART

Pale, blue, faint, weak pulse, dizzy



THROAT

Tight, hoarse, trouble breathing/ swallowing



MOUTH

Significant swelling of the tongue and/or lips



SKIN

Many hives over body, widespread redness



GUT

Repetitive vomiting or severe diarrhea



OTHER

Feeling something bad is about to happen, anxiety, confusion

OR A COMBINATION of mild or severe symptoms from different body areas.

NOTE: Do not depend on antihistamines or inhalers (bronchodilators) to treat a severe reaction. Use Epinephrine.

1. **INJECT EPINEPHRINE IMMEDIATELY.**
2. **Call 911.** Request ambulance with epinephrine.
 - Consider giving additional medications (following or with the epinephrine):
 - » Antihistamine
 - » Inhaler (bronchodilator) if asthma
 - Lay the student flat and raise legs. If breathing is difficult or they are vomiting, let them sit up or lie on their side.
 - If symptoms do not improve, or symptoms return, more doses of epinephrine can be given about 5 minutes or more after the last dose.
 - Alert emergency contacts.
 - Transport student to ER even if symptoms resolve. Student should remain in ER for 4+ hours because symptoms may return.

NOTE: WHEN IN DOUBT, GIVE EPINEPHRINE.

MILD SYMPTOMS

If checked, give epinephrine immediately for ANY symptoms if the allergen was likely eaten.



NOSE

Itchy/runny nose, sneezing



MOUTH

Itchy mouth



SKIN

A few hives, mild itch



GUT

Mild nausea/discomfort



1. **GIVE ANTIHISTAMINES, IF ORDERED BY PHYSICIAN**
2. Stay with student; alert emergency contacts.
3. Watch student closely for changes. If symptoms worsen, **GIVE EPINEPHRINE.**

MEDICATIONS/DOSES

Epinephrine Brand: _____

Epinephrine Dose: 0.15 mg IM 0.3 mg IM

Antihistamine Brand or Generic: _____

Antihistamine Dose: _____

Other (e.g., inhaler-bronchodilator if asthmatic): _____

PARENT/GUARDIAN AUTHORIZATION SIGNATURE

DATE

PHYSICIAN/HCP AUTHORIZATION SIGNATURE

DATE



EPIPEN® (EPINEPHRINE) AUTO-INJECTOR DIRECTIONS

1. Remove the EpiPen Auto-Injector from the plastic carrying case.
2. Pull off the blue safety release cap.
3. Swing and firmly push orange tip against mid-outer thigh.
4. Hold for approximately 10 seconds.
5. Remove and massage the area for 10 seconds.

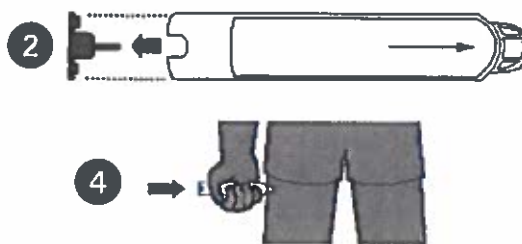

AUVI-Q™ (EPINEPHRINE INJECTION, USP) DIRECTIONS

1. Remove the outer case of Auvi-Q. This will automatically activate the voice instructions.
2. Pull off red safety guard.
3. Place black end against mid-outer thigh.
4. Press firmly and hold for 5 seconds.
5. Remove from thigh.

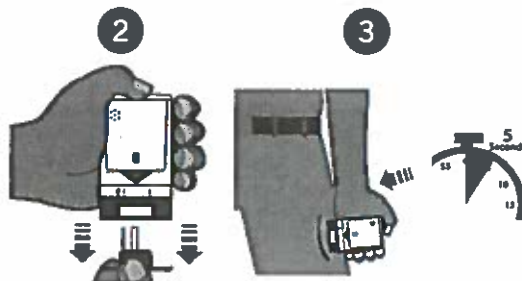

ADRENACLICK®/ADRENACLICK® GENERIC DIRECTIONS

1. Remove the outer case.
2. Remove grey caps labeled "1" and "2".
3. Place red rounded tip against mid-outer thigh.
4. Press down hard until needle penetrates.
5. Hold for 10 seconds. Remove from thigh.



OTHER DIRECTIONS/INFORMATION (may self-carry epinephrine, may self-administer epinephrine, etc.):

Treat student before calling Emergency Contacts. The first signs of a reaction can be mild, but symptoms can get worse quickly.

EMERGENCY CONTACTS — CALL 911

RESCUE SQUAD: _____
 DOCTOR: _____ PHONE: _____
 PARENT/GUARDIAN: _____ PHONE: _____

OTHER EMERGENCY CONTACTS

NAME/RELATIONSHIP: _____
 PHONE: _____
 NAME/RELATIONSHIP: _____
 PHONE: _____

PARENT/GUARDIAN AUTHORIZATION SIGNATURE

DATE